

CONCRETE EDGE STRIP AND "NO ROAD" SIGN TEMPORARY AG AT EDGE STRIP

TEMPORARY TURNING CIRCLE (150mm DEPTH OF CLASS 3 CR) WITH POST & WIRE FENCE AROUND TURNING AREA  
CONCRETE EDGE STRIP AND "NO ROAD" SIGN TEMPORARY AG AT EDGE STRIP

CONCRETE EDGE STRIP AND "NO ROAD" SIGN TEMPORARY AG AT EDGE STRIP

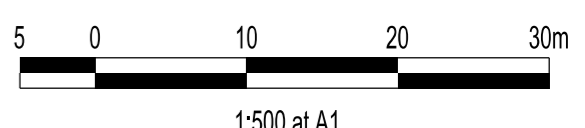

REFER TO MELBOURNE WATER PLAN FOR DETAILS

TEMPORARY TURNING CIRCLE (150mm DEPTH OF CLASS 3 CR) WITH POST & WIRE FENCE AROUND TURNING AREA  
CONCRETE EDGE STRIP AND "NO ROAD" SIGN TEMPORARY AG AT EDGE STRIP

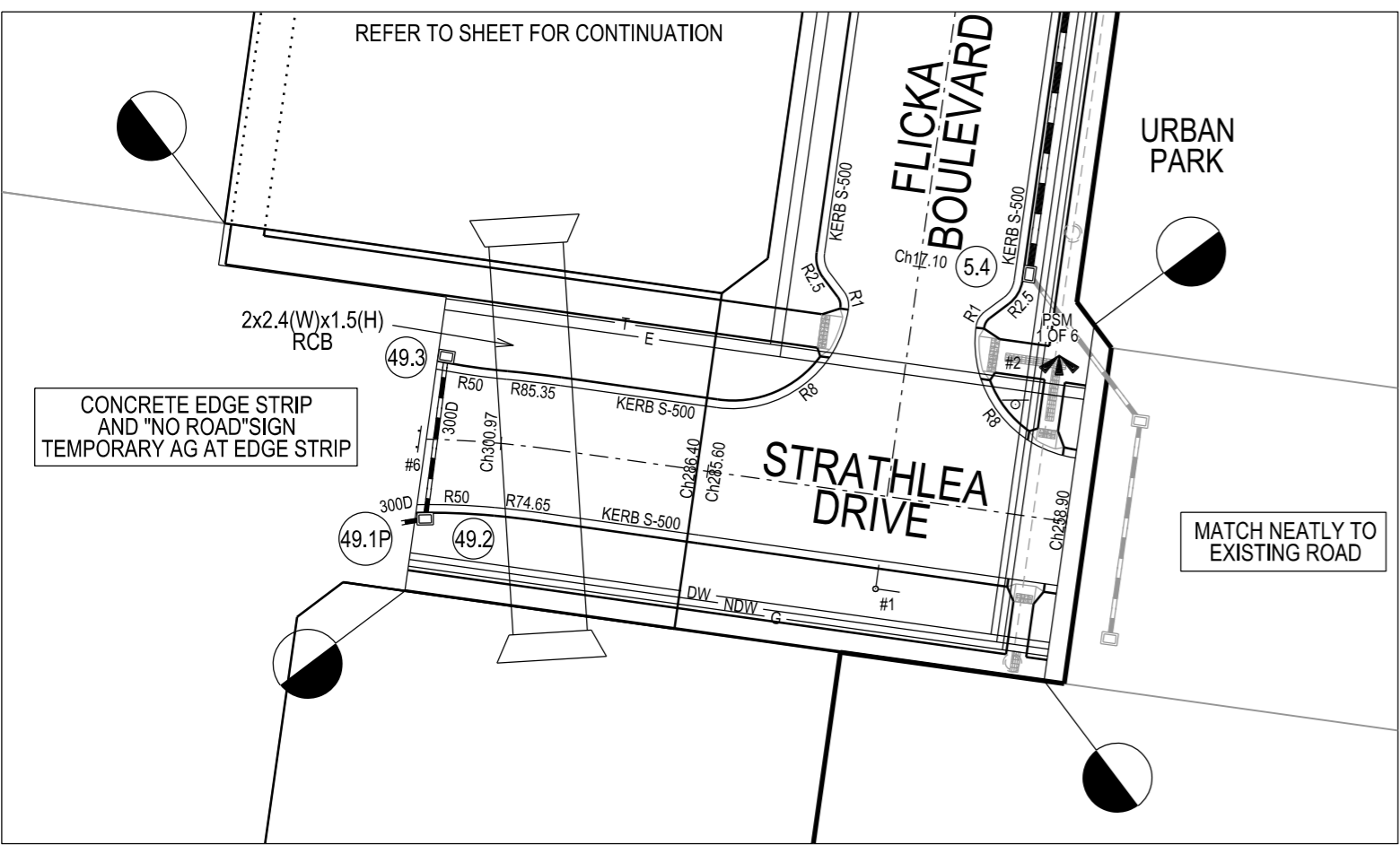

**LEGEND**

- FOOTPATH
- VEHICULAR CROSSOVER
- KERB AND CHANNEL
- ELECTRICITY TELECOMMUNICATION } CONDUITS
- GAS DRINKING WATER NON DRINKING WATER } CONDUITS
- E — ELECTRICITY MAIN
- T — TELECOMMUNICATION MAIN
- G — GAS MAIN
- DW — DRINKING WATER MAIN
- NDW — NON DRINKING WATER MAIN
- S — SEWER MAIN, MANHOLE AND MAINTENANCE SHAFT
- PROPOSED DRAINAGE, PIT, HOUSE DRAIN AND PROPERTY INLET
- EXISTING DRAINAGE AND PIT AND FUTURE DRAINAGE AND PIT
- (0.00) DRAINAGE PIT NUMBER
- PROPOSED CUT AREAS
- PROPOSED FILL AREAS
- E00.00 EXISTING SURFACE LEVEL
- D00.00 DESIGN SURFACE LEVEL
- B00.00 TOP OF BATTER LEVEL
- P000.00 PRE-DEVELOPMENT LEVEL
- #1 STREET NAME SIGN
- LOT SLOPE DIRECTION
- PERMANENT SURVEY MARK
- TEMPORARY BENCH MARK
- RETAINING WALLS

**SERVICE OFFSETS**

Street	Gas	NDW	Water	Comms	Elec.	Lighting
Strathlea Drive	S 1.85	S 2.35	S 2.85	N 3.225	N 4.05	1.00 BOK
Flicka Boulevard	E 1.85	E 2.35	E 2.85	W 1.075	W 1.90	1.00 BOK
Henrietta Place	S 1.85	S 2.35	S 2.85	N 1.775	N 2.60	1.00 BOK
Wanstead Way	N 1.85	N 2.35	N 2.85	S 1.775	S 2.60	1.00 BOK
Tony Way	S 1.85	S 2.35	S 2.85	N 1.775	N 2.60	1.00 BOK
Remus Circuit (Lot 215 - Lot 223)	S 1.85	S 2.35	S 2.85	N 1.775	N 2.60	1.00 BOK
Remus Circuit (Lot 214)	S 1.00	S 1.50	S 2.00	-	-	-
Remus Circuit (Lot 209 - Lot 212)	E 1.85	E 2.35	E 2.85	W 1.775	W 2.60	1.00 BOK

SERVICE OFFSETS ARE MEASURED (m) FROM THE TITLE BOUNDARY UNLESS OTHERWISE SPECIFIED

**WARNING**  
BEWARE OF UNDERGROUND SERVICES  
THE LOCATIONS OF UNDERGROUND SERVICES ARE APPROXIMATE ONLY AND THEIR EXACT POSITION SHOULD BE PROVEN ON SITE. NO GUARANTEE IS GIVEN THAT ALL EXISTING SERVICES ARE SHOWN.

**STOP**  
Major Cables exist in the area, if your activities are within Telstra encroachment distances (see duty of care) contact 03 9632 9961 at least 2 business days before starting activity.

STAGE 1 COMMUNITY CENTRE

<b>VERSION DETAILS:</b>				DRAWN: ZWL	DATE: MAY 2016	SCALE: AS SHOWN
REV	DATE	DESCRIPTION	STATUS	DESIGNED: JT	DATE: MAY 2016	DATE PRINTED: 13/05/2016
-	13/05/16		PRELIMINARY	AUTHORISED: ASC	DATE: MAY 2016	
				<p>LAND DEVELOPMENT CONSULTANTS</p> <p>SUITE 1, LEVEL 1, 84 MT ELIZA WAY, MT ELIZA VIC 3930 www.charltondegg.com.au</p>		
				<p>COUNCIL: CITY OF CASEY</p> <p>TITLE: CRANBOURNE PROJECT PTY LTD LOCHAVEN - STAGE 2 665 HALL ROAD - CRANBOURNE WEST</p>		
				<p>DETAIL PLAN &amp; SOT</p>		
FILENAME: P:\104111041_2\IE2 - Design\6 - DGN\R04.dgn				DRG NO: 1041_2/R04	REV: -	SHEET 4 OF XX

PASSIVE OPEN SPACE

REFER TO INSERT FOR CONTINUATION